



# Delta<sup>®</sup>-MS

DryDog Barriers • 888-5-DRYDOG

**Delta<sup>®</sup>-MS** is a highly effective waterproofing protection system based on a uniquely formed air-gap membrane. The main component of **DELTA<sup>®</sup>-MS** is the plastic (HDPE) membrane, formed in a dimple pattern to create an air-gap at the foundation wall. This unique design allows any water getting past the dimpled plastic sheet to fall freely to the footer drain. This membrane is remarkably impermeable to water and water vapor and impervious to acids and other agents. **DELTA<sup>®</sup>-MS** HDPE is tough, resilient and durable with an expected service life of more than 50 years.

## Specifications

Material	High Density Polyethylene (HDPE)
Color:	Brown
Dimple Height:	5/16" (8 mm)
Working Temperature:	-22°F to + 176°F -30°C to + 80°C
Air-Gap Volume:	~ 0.13 gal/ft. <sup>2</sup> (5.3 litres/m <sup>2</sup> )
Compressive Strength:	~5200 psf (-250 kN/m <sup>2</sup> )
Water Flow Rate (V)(GR=1):	12 gal/ min/ft (149 L/ min/m)
Water Flow Rate (H)(GR=1):	3.5 gal/ min/ft (44 L/min/m)
U.V. Stability:	Good
Bacteria Attack:	Unaffected
Toxicity:	Non-toxic, nonpolluting
Freeze Thaw Cycle:	Unaffected
Service Life Expectancy:	The Life Of The Structure

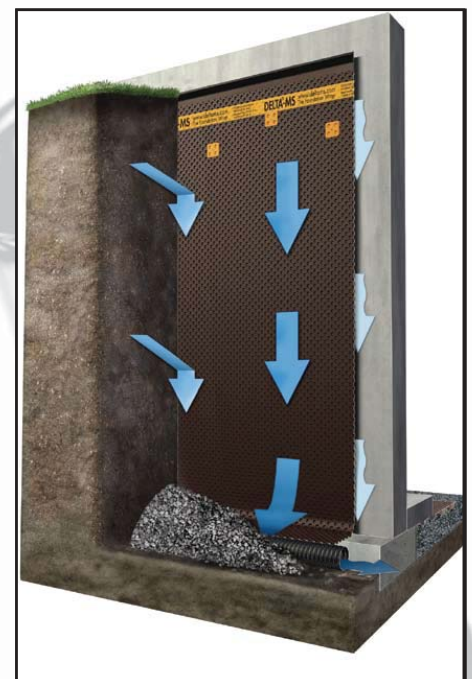
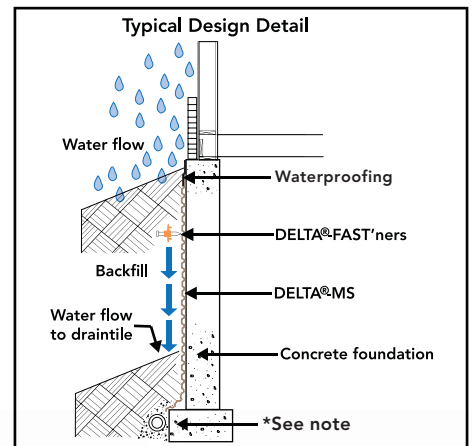

For more application information visit [www.drydogbarriers.com](http://www.drydogbarriers.com) or email us [info@drydogbarriers.com](mailto:info@drydogbarriers.com)

\*Note: The footer drain only needs to be beside the footer if the top of the slab is less than 6" from the top of the footer.